

RC納まり

鉛直断面

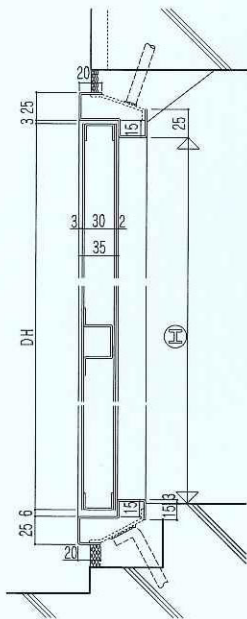

水平断面

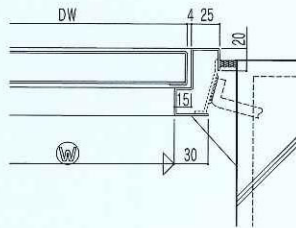

軽鉄納まり

鉛直断面

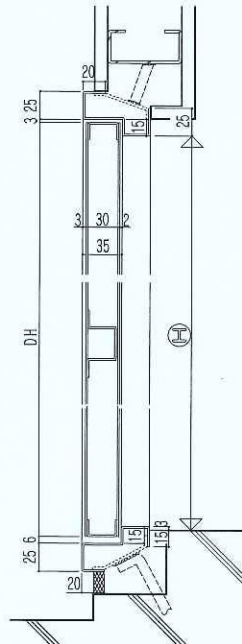

水平断面

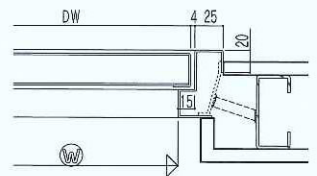

A L C納まり

鉛直断面

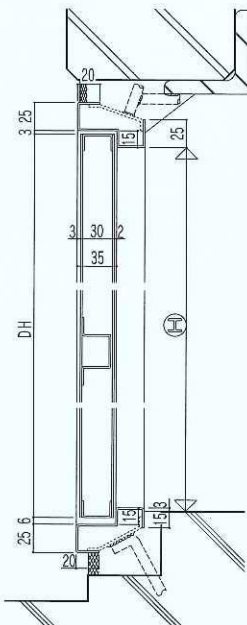

水平断面

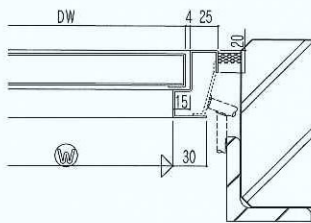

木造納まり

鉛直断面

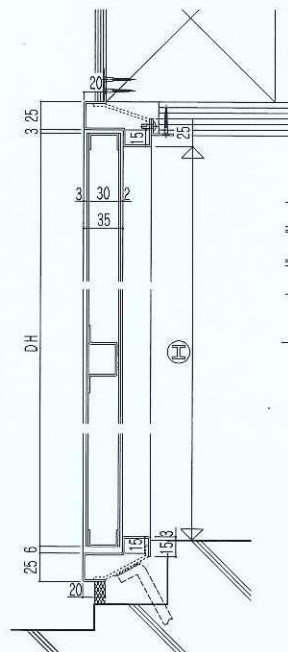

水平断面

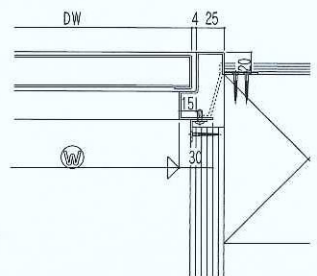

下段片開きタイプ

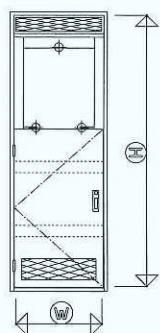

⊕ : 給湯器受けビス穴

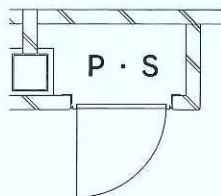

全面片開きタイプ

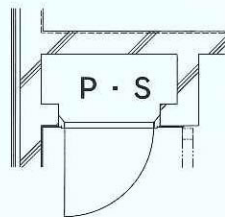
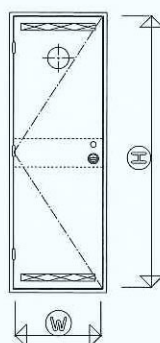

下段両開きタイプ

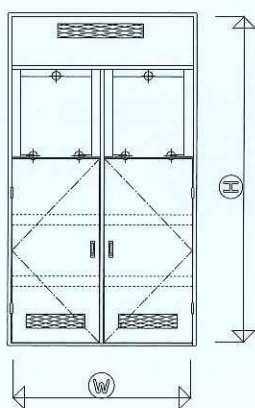

⊕ : 給湯器受けビス穴

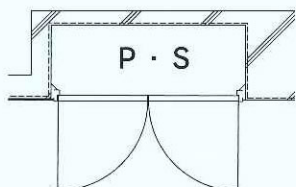

パネル付(コーナー)タイプ

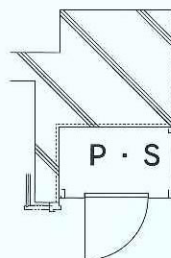
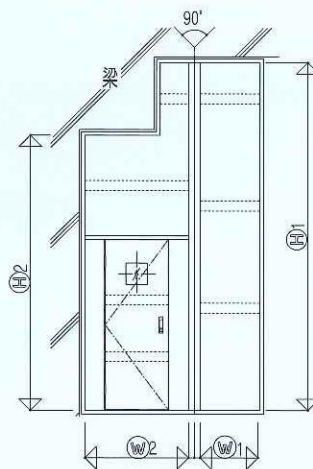

下段片開き鉛直断面

全面片開き鉛直断面

ガス機器受け詳細図

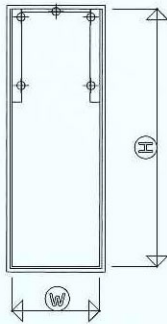

⊕ : 給湯器受けビス穴

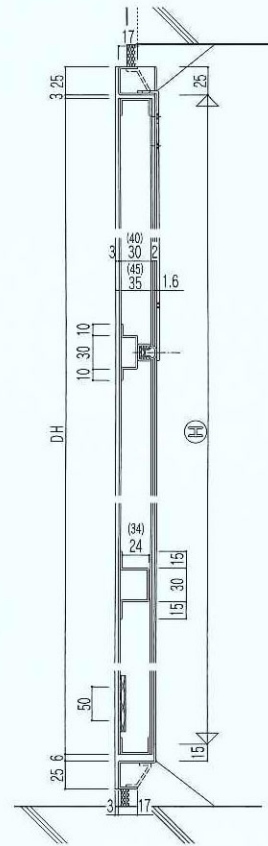
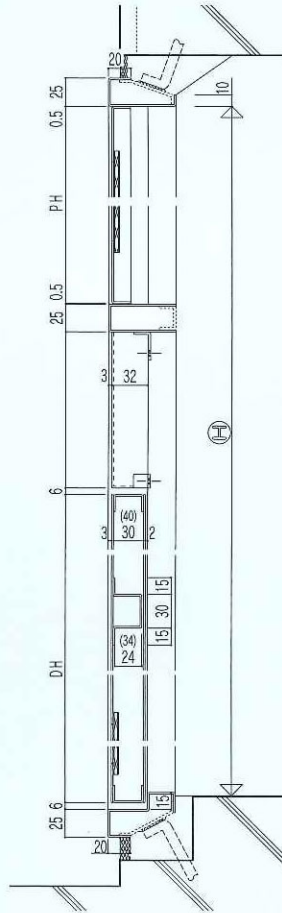

上部通風口水平断面 (エキスパンドメタル)

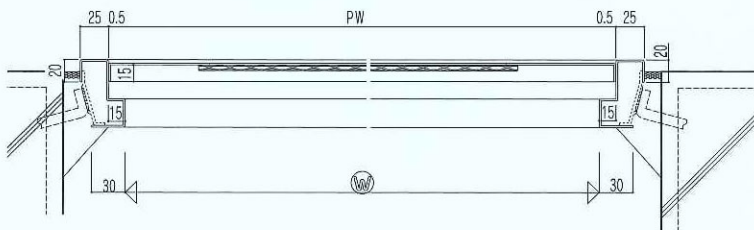

扉部通風口水平断面 (エキスパンドメタル)

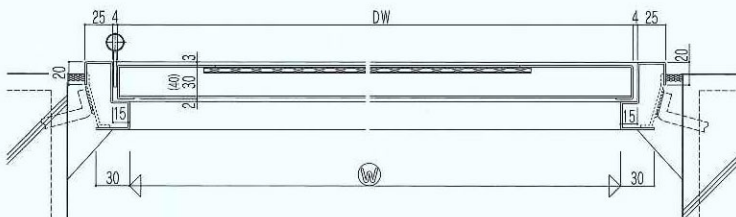

隠し丁番使用

扉表面材 0.8mm

姿図

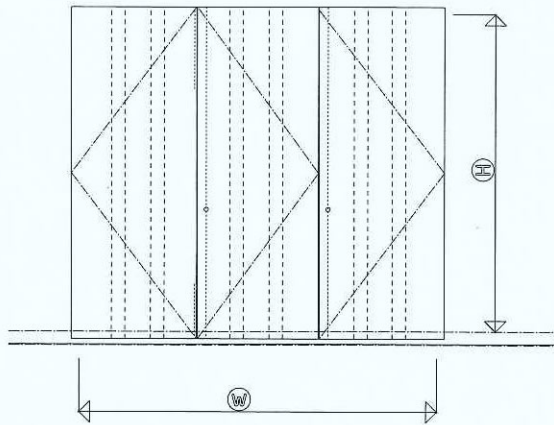

鉛直断面

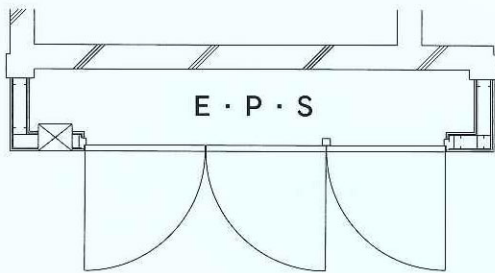
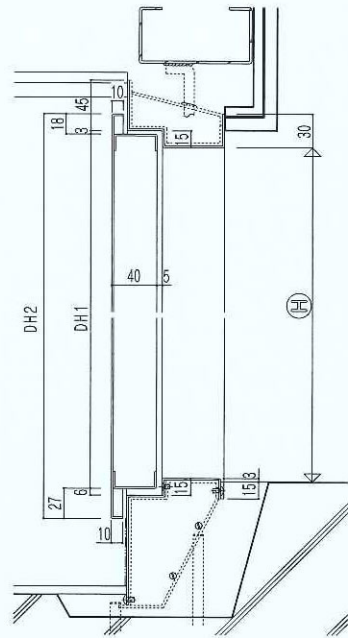

ロックハンドル

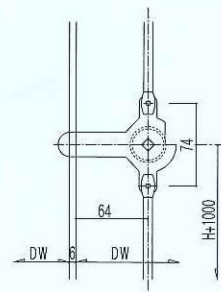

水平断面

